

WEST SUSSEX COUNTY COUNCIL
((CRAWLEY BOROUGH) (PARKING PLACES AND TRAFFIC REGULATION)
(CONSOLIDATION) ORDER 2010)
(EAST CRAWLEY SCHOOL KEEP CLEAR AMENDMENT) ORDER 2016

CRAWLEY: LOCATION OF WAITING RESTRICTIONS

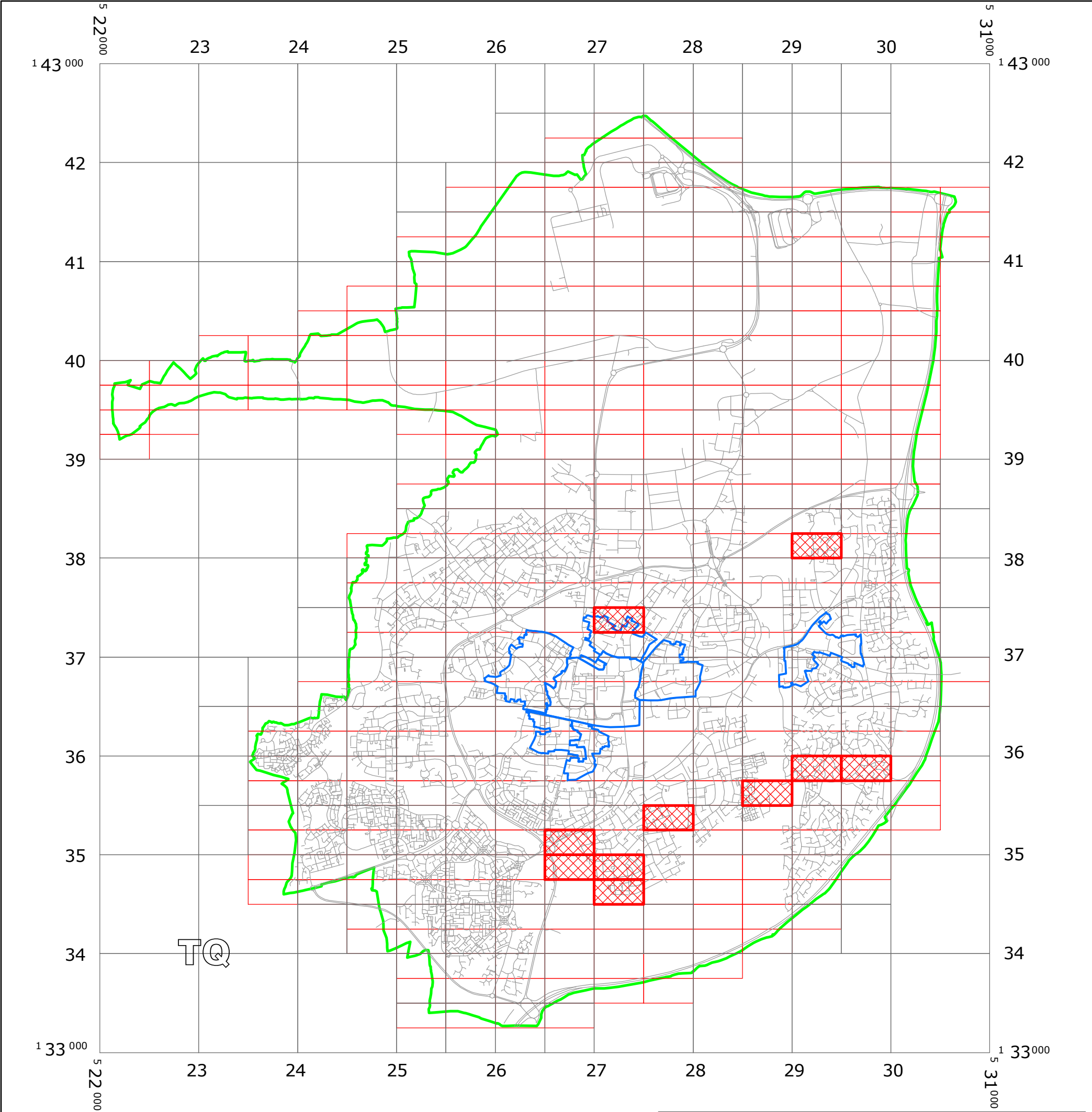

KEY:

OS TILE GRID

PARKING TILE GRID

LOCATION OF WAITING RESTRICTIONS

PARISH BOUNDARY

CONTROLLED PARKING ZONE BOUNDARY

ROAD NETWORK

Key for Waiting Restrictions

All areas over which the provision of the orders apply are defined by the shaded areas as shown on the following plans plus a contiguous area not indicated on the plans of verge and/or footway between the carriageway edge and the highway boundary. The plans in this schedule are based upon grid references of the Ordnance Survey National Grid defined by the OSGB 36 triangulation.

Prohibition of waiting at any time

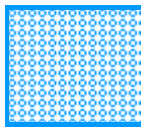
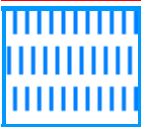
101		check	No waiting at any time	171		circle4	No waiting 8.00am-10.00am Mon-Sat except bank holidays
158		pat 046	No waiting 9.00am-5.00pm Mon-Sat except bank holidays				

Residents Parking

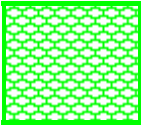
512		usgs503	Residents' and Visitors' permit holders only 9.00am-5.00pm Mon-Sat except bank holidays
-----	--	---------	--

Clearways

1100		usgs503	School Keep Clear-No stopping at any time	1103		herring3	Bus stop clearway at any time
1102		pat062	24hr Rural Clearway	1104		usgs620	Bus stop clearway 7.00am-7.00pm any day

 Boundary of Controlled Parking Zone

6222.

West Sussex County Council in exercise of their powers under Sections 1 (1) 2 (1) and (2), 4 (2), 45, 46, 49 and 53 and Part IV of Schedule 9 of the Road Traffic Regulation Act 1984 "the Act" as amended and of all other enabling powers and after consultation with the chief officer of police in accordance with Part III of Schedule 9 to the Act hereby make the following Order:-

1. This Order shall come into operation on the 16th day of May 2016 and may be cited as "West Sussex County Council ((Crawley Borough) (Parking Places and Traffic Regulation) (Consolidation) Order 2010) (East Crawley School Keep Clear Amendment) Order 2016."
2. The "West Sussex County Council (Crawley Borough) (Parking Places and Traffic Regulation) (Consolidation) Order 2010" is hereby amended by the deletion from it of the plans in the First Schedule to this Order, and the substitution of the plans attached in the Second Schedule to this Order.

FIRST SCHEDULE
Plans to be deleted

TQ2634NEN (Sheet Issue No. 1)
TQ2635SES (Sheet Issue No. 2)
TQ2734NWN (Sheet Issue No. 1)
TQ2734NWS (Sheet Issue No. 2)
TQ2735SEN (Sheet Issue No. 1)
TQ2737SWN (Sheet Issue No. 6)
TQ2835NES (Sheet Issue No. 1)
TQ2935NEN (Sheet Issue No. 1)
TQ2935NWN (Sheet Issue No. 1)
TQ2938SWS (Sheet Issue No. 2)

I HEREBY CERTIFY THIS TO
BE A TRUE COPY OF THE
ORIGINAL DOCUMENT

Authorised Officer

WEST SUSSEX COUNTY COUNCIL

SECOND SCHEDULE
Plans to be substituted
(as attached)

TQ2634NEN (Sheet Issue No. 2)
TQ2635SES (Sheet Issue No. 3)
TQ2734NWN (Sheet Issue No. 2)
TQ2734NWS (Sheet Issue No. 3)
TQ2735SEN (Sheet Issue No. 2)
TQ2737SWN (Sheet Issue No. 7)
TQ2835NES (Sheet Issue No. 2)
TQ2935NEN (Sheet Issue No. 2)
TQ2935NWN (Sheet Issue No. 2)
TQ2938SWS (Sheet Issue No. 3)

THE COMMON SEAL of WEST SUSSEX
COUNTY COUNCIL was hereto affixed

the TENTH day of May 2016
in the presence of:

Dise Penham

Authorised Signatory



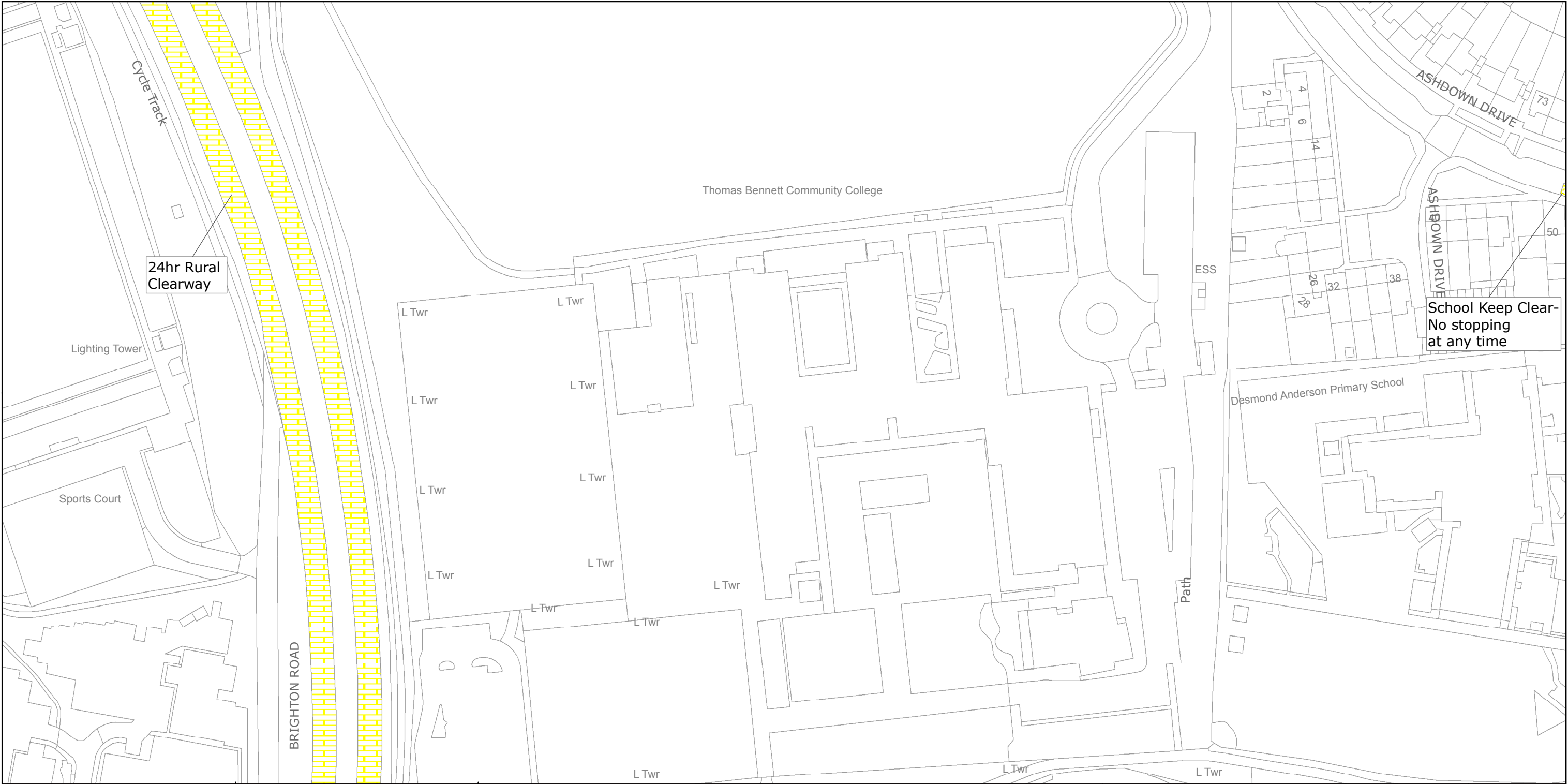

West Sussex County Council
Highways & Transport
The Grange
Tower Street
Chichester
West Sussex
PO19 1RH

CRAWLEY BOROUGH: BROADFIELD SOUTH AND
TILGATE WARDS

WAITING RESTRICTIONS

Reproduced from or based upon 2013 Ordnance Survey material with permission of the Controller of HMSO (c) Crown Copyright reserved.
Unauthorised reproduction infringes Crown copyright and may lead to prosecution or civil proceedings West Sussex County Council Licence No. 100023447

TILE REF NO:
TQ2634NEN

SHEET ISSUE NO 2
SHEET ACTIVE FROM - 16/05/2016

N

SCALE:
1:1250
at A3 size

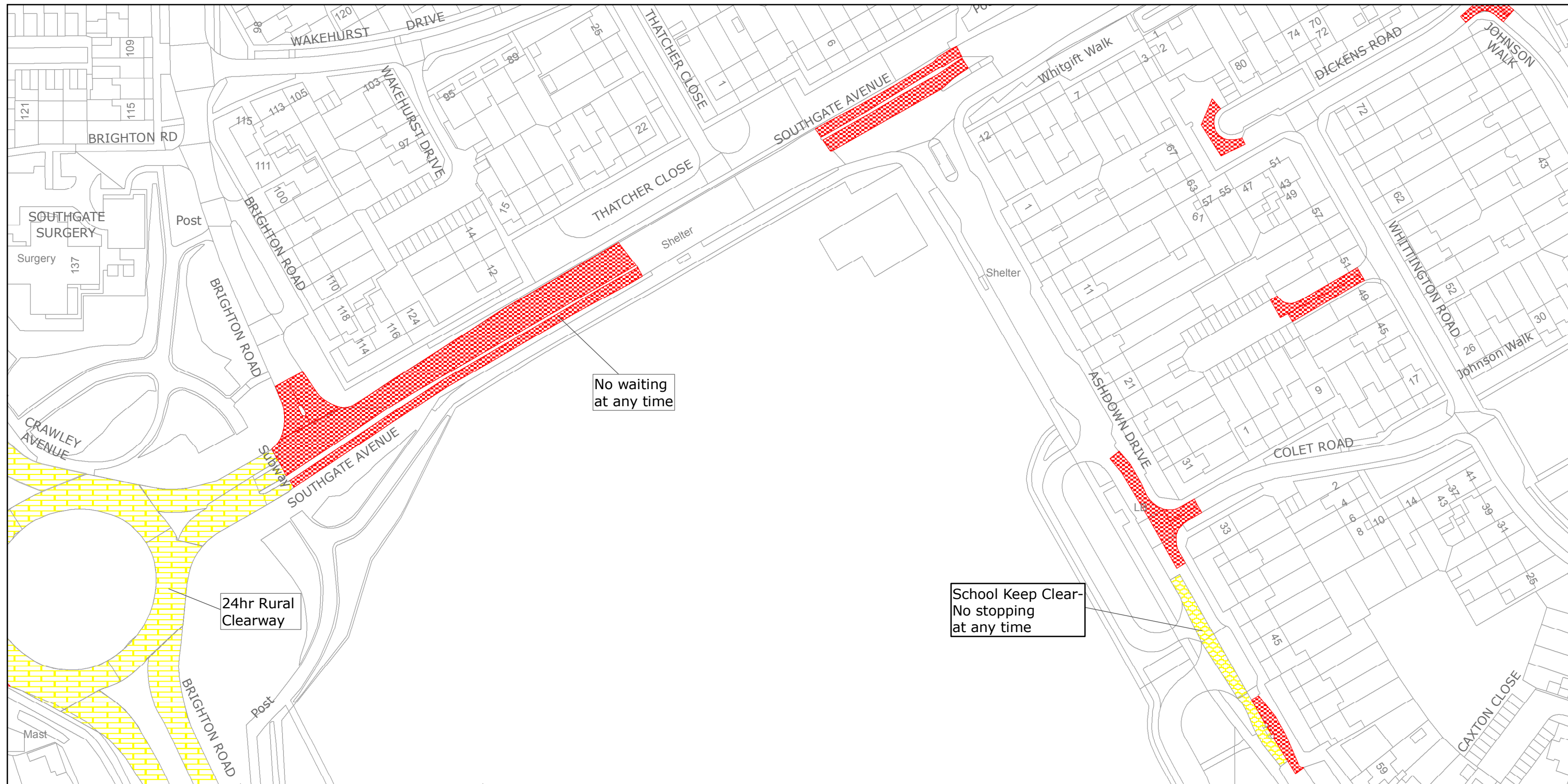

West Sussex County Council
Highways & Transport
The Grange
Tower Street
Chichester
West Sussex
PO19 1RH

CRAWLEY BOROUGH: BROADFIELD NORTH,
BROADFIELD SOUTH, SOUTHGATE
AND TILGATE WARDS

WAITING RESTRICTIONS

Reproduced from or based upon 2013 Ordnance Survey material with permission of the Controller of HMSO (c) Crown Copyright reserved.
Unauthorised reproduction infringes Crown copyright and may lead to prosecution or civil proceedings West Sussex County Council Licence No. 100023447

TILE REF NO:
TQ2635SES

SHEET ISSUE NO 3
SHEET ACTIVE FROM - 16/05/2016



SCALE:
1:1250
at A3 size



West Sussex County Council
Highways & Transport
The Grange
Tower Street
Chichester
West Sussex
PO19 1RH

CRAWLEY BOROUGH: TILGATE WARD
WAITING RESTRICTIONS

Reproduced from or based upon 2013 Ordnance Survey material with permission of the Controller of HMSO (c) Crown Copyright reserved.
Unauthorised reproduction infringes Crown copyright and may lead to prosecution or civil proceedings West Sussex County Council Licence No. 100023447

TILE REF NO:
TQ2734NWN

SHEET ISSUE NO 2
SHEET ACTIVE FROM - 16/05/2016



SCALE:
1:1250
at A3 size



West Sussex County Council
Highways & Transport
The Grange
Tower Street
Chichester
West Sussex
PO19 1RH

CRAWLEY BOROUGH: TILGATE WARD

WAITING RESTRICTIONS

Reproduced from or based upon 2013 Ordnance Survey material with permission of the Controller of HMSO (c) Crown Copyright reserved.
Unauthorised reproduction infringes Crown copyright and may lead to prosecution or civil proceedings West Sussex County Council Licence No. 100023447

TILE REF NO: TQ2734NWS

SHEET ISSUE NO 3
SHEET ACTIVE FROM - 16/05/2016



SCALE:
1:1250
at A3 size

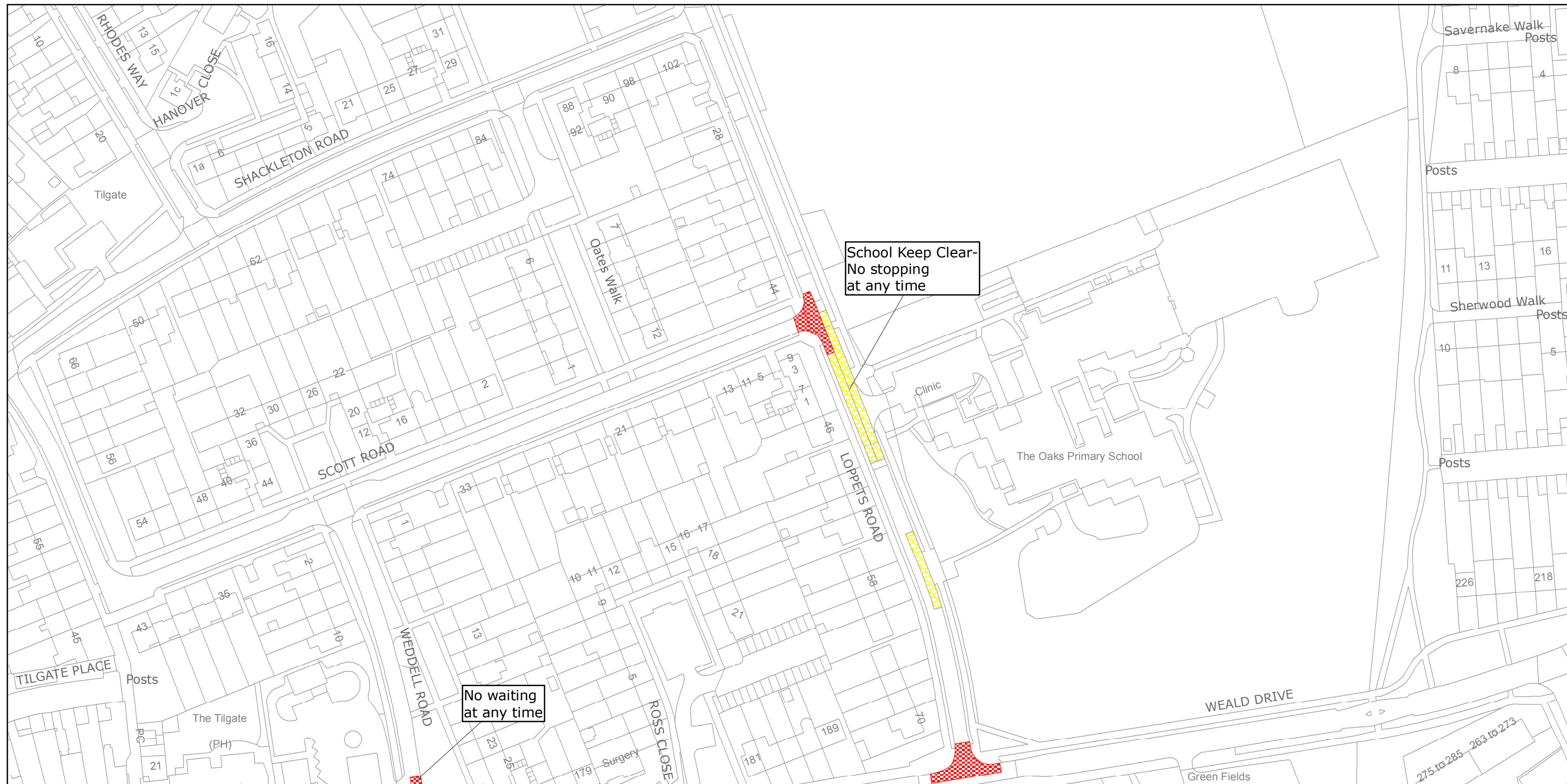

West Sussex County Council
Highways & Transport
The Grange
Tower Street
Chichester
West Sussex
PO19 1RH

CRAWLEY BOROUGH: FURNACE GREEN
AND TILGATE WARDS

WAITING RESTRICTIONS

Reproduced from or based upon 2013 Ordnance Survey material with permission of the Controller of HMSO (c) Crown Copyright reserved.
Unauthorised reproduction infringes Crown copyright and may lead to prosecution or civil proceedings West Sussex County Council Licence No. 100023447

TILE REF NO:
TQ2735SEN

SHEET ISSUE NO 2
SHEET ACTIVE FROM - 16/05/2016



SCALE:
1:1250
at A3 size

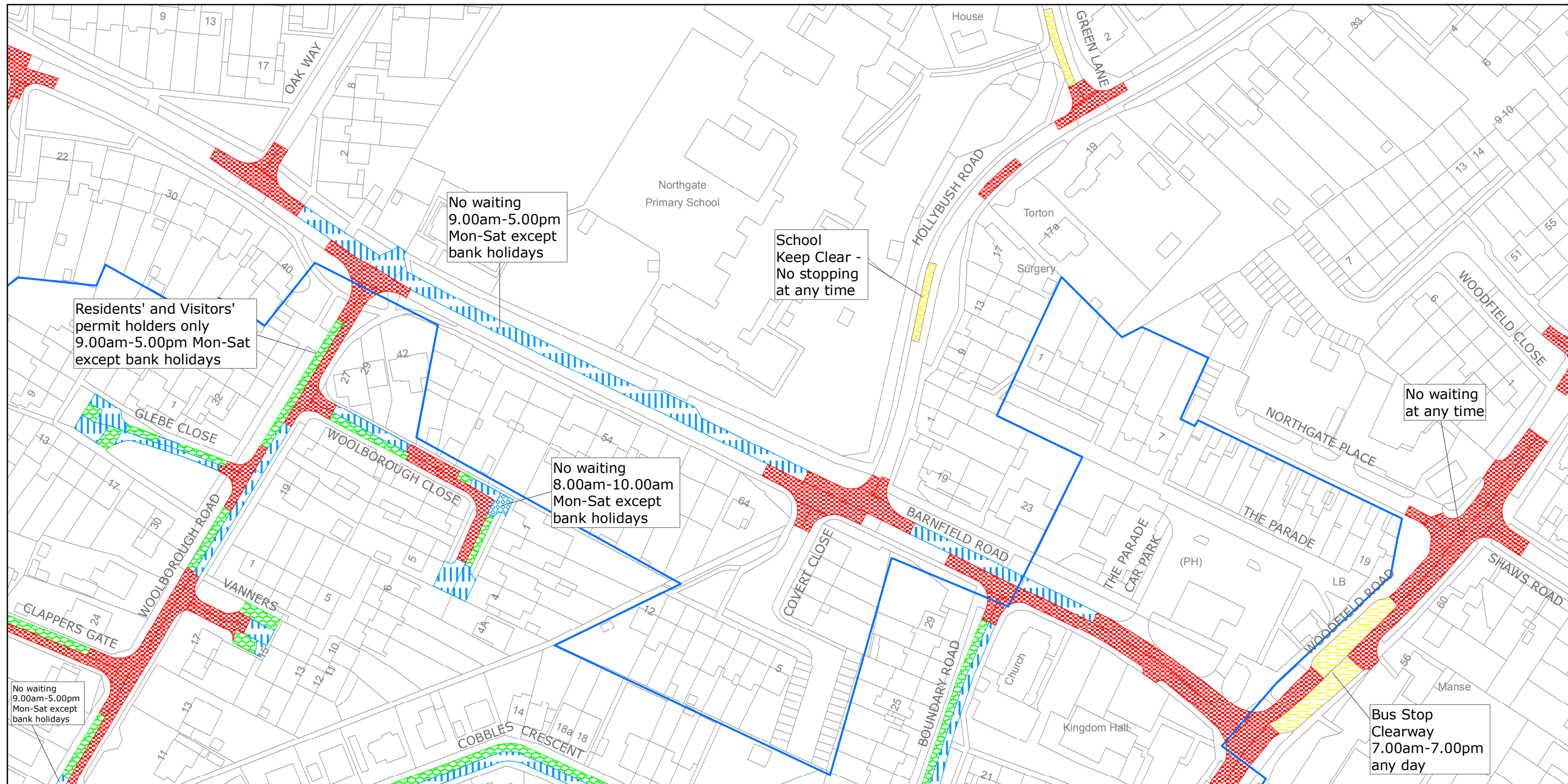

West Sussex County Council
Highways & Transport
The Grange
Tower Street
Chichester
West Sussex
PO19 1RH

CRAWLEY BOROUGH: NORTHGATE AND WEST GREEN WARDS

WAITING RESTRICTIONS

Reproduced from or based upon 2013 Ordnance Survey material with permission of the Controller of HMSO (c) Crown Copyright reserved.
Unauthorised reproduction infringes Crown copyright and may lead to prosecution or civil proceedings West Sussex County Council Licence No. 100023447

**TILE REF NO:
TQ2737SWN**

SHEET ISSUE NO 7
SHEET ACTIVE FROM - 16/05/2016



SCALE:
1:1250
at A3 size



West Sussex County Council
Highways & Transport
The Grange
Tower Street
Chichester
West Sussex
PO19 1RH

CRAWLEY BOROUGH: MAIDENBOWER WARD
WAITING RESTRICTIONS

Reproduced from or based upon 2013 Ordnance Survey material with permission of the Controller of HMSO (c) Crown Copyright reserved.
Unauthorised reproduction infringes Crown copyright and may lead to prosecution or civil proceedings West Sussex County Council Licence No. 100023447

TILE REF NO:
TQ2835NES

SHEET ISSUE NO 2
SHEET ACTIVE FROM - 16/05/2016



SCALE:
1:1250

at A3 size

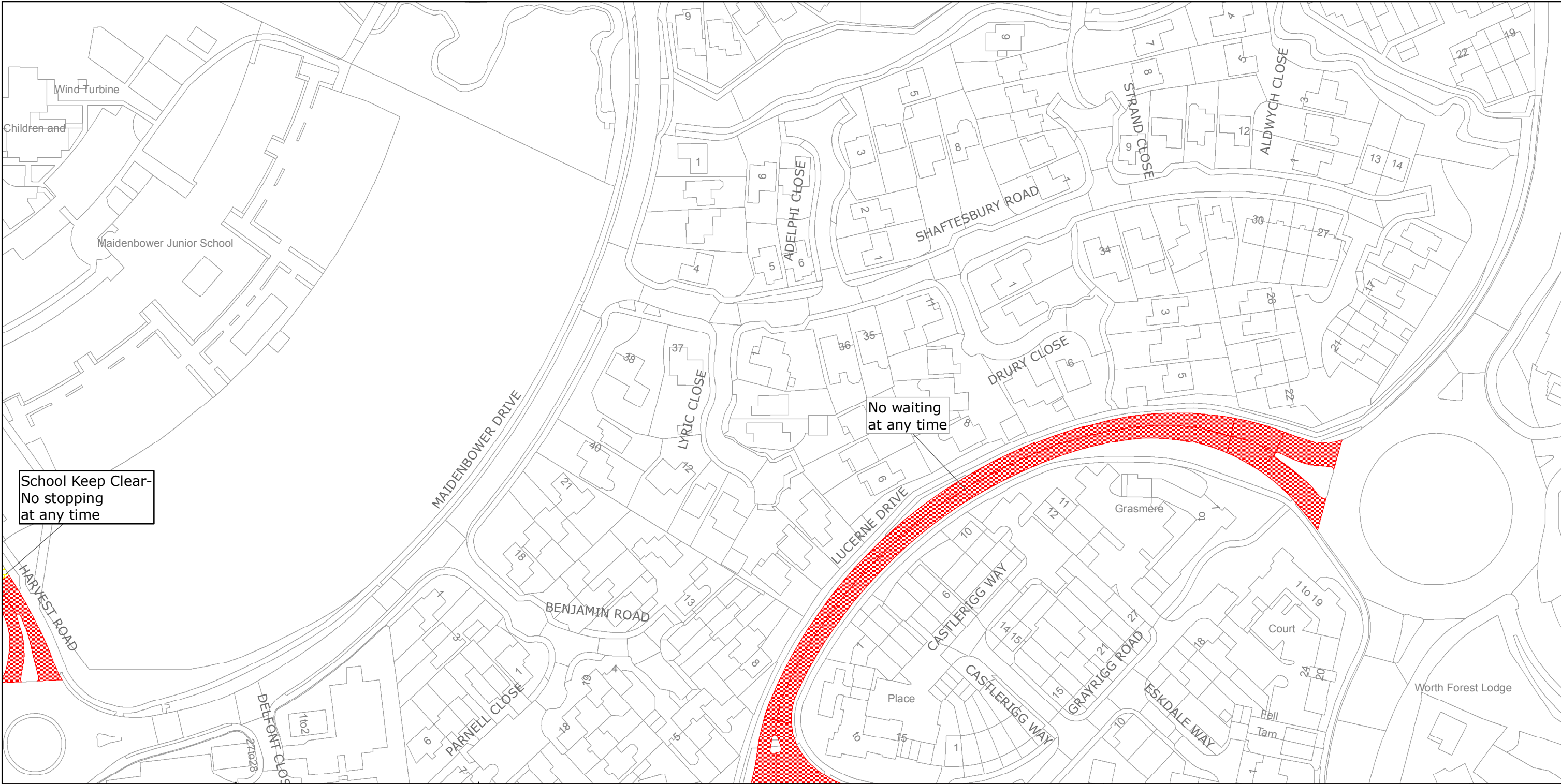

West Sussex County Council
Highways & Transport
The Grange
Tower Street
Chichester
West Sussex
PO19 1RH

CRAWLEY BOROUGH: MAIDENBOWER WARD

WAITING RESTRICTIONS

Reproduced from or based upon 2013 Ordnance Survey material with permission of the Controller of HMSO (c) Crown Copyright reserved.
Unauthorised reproduction infringes Crown copyright and may lead to prosecution or civil proceedings West Sussex County Council Licence No. 100023447

TILE REF NO:
TQ2935NEN

SHEET ISSUE NO 2
SHEET ACTIVE FROM - 16/05/2016



SCALE:
1:1250

at A3 size



West Sussex County Council
Highways & Transport
The Grange
Tower Street
Chichester
West Sussex
PO19 1RH

CRAWLEY BOROUGH: MAIDENBOWER WARD

WAITING RESTRICTIONS

Reproduced from or based upon 2013 Ordnance Survey material with permission of the Controller of HMSO (c) Crown Copyright reserved.
Unauthorised reproduction infringes Crown copyright and may lead to prosecution or civil proceedings West Sussex County Council Licence No. 100023447

TILE REF NO:
TQ2935NWN

SHEET ISSUE NO 2
SHEET ACTIVE FROM - 16/05/2016



SCALE:
1:1250
at A3 size



West Sussex County Council
Highways & Transport
The Grange
Tower Street
Chichester
West Sussex
PO19 1RH

CRAWLEY BOROUGH: POUND HILL NORTH WARD
WAITING RESTRICTIONS

Reproduced from or based upon 2013 Ordnance Survey material with permission of the Controller of HMSO (c) Crown Copyright reserved.
Unauthorised reproduction infringes Crown copyright and may lead to prosecution or civil proceedings West Sussex County Council Licence No. 100023447

TILE REF NO:
TQ2938SWS

SHEET ISSUE NO 3
SHEET ACTIVE FROM - 16/05/2016



SCALE:
1:1250
at A3 size